

J TYPE HANGER

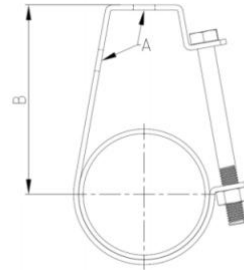

Function: Designed for the suspension of stationary piping systems. The “T” slot in the hanger permits the side bolt to be installed after installation and setting of pipe. The side hole permits optional wall mounting.

Material: Carbon steel

Finish: Electro-galvanized

Approvals: Factory Mutual Approved for steel pipe sizes 3/4"to 12. Complies with Manufacturers' Standardization Society ANSI/MSS SP-58 (Type 5) which supersedes ANSI/MSS SP-69.

Maximum Temperature: 343°C (650°F)

Ordering: Specify size

Item	Size	Specification of bolts and Size		A		B	Max. Rec. Load		
		mm	in	mm	in		mm	Lbs	Kg
GSJ9	1/2"	M6	1/4"-20UNC	M10	3/8"-16UNC	54	299	135	1334
GSJ9	3/4"	M6	1/4"-20UNC	M10	3/8"-16UNC	60	299	135	1334
GSJ9	1"	M6	1/4"-20UNC	M10	3/8"-16UNC	66	299	135	1334
GSJ9	1-1/4"	M6	1/4"-20UNC	M10	3/8"-16UNC	71	299	135	1334
GSJ9	1-1/2"	M6	1/4"-20UNC	M10	3/8"-16UNC	78	299	135	1334
GSJ9	2"	M6	1/4"-20UNC	M10	3/8"-16UNC	89	299	135	1334
GSJ9	2-1/2"	M10	3/8"-16UNC	M10	3/8"-16UNC	113	339	153	1512
GSJ9	3"	M10	3/8"-16UNC	M10	3/8"-16UNC	124	419	189	1868
GSJ9	3-1/2"	M10	3/8"-16UNC	M10	3/8"-16UNC	132	499	225	2224
GSJ9	4"	M10	3/8"-16UNC	M10	3/8"-16UNC	156	599	270	2668
GSJ9	5"	M10	3/8"-16UNC	M12	1/2"-13UNC	171	799	360	3558
GSJ9	6"	M10	3/8"-16UNC	M12	1/2"-13UNC	197	1059	477	4714
GSJ9	8"	M10	3/8"-16UNC	M16	5/8"-11UNC	235	1619	729	7205
GSJ9	10"	M10	3/8"-16UNC	M16	5/8"-11UNC	275	2339	1053	10408
GSJ9	12"	M10	3/8"-16UNC	M16	5/8"-11UNC	310	3159	1422	14055