

Grooved Eccentric Reducer

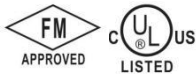

- Certificate: FM Approved / UL Listed
- Size: 3"×2" - 8"×6" (DN 80×50 - DN 200×150)
- Pressure: 300PSI
- Dimensions: ANSI B16.3
- Material: ASTM A536, GRADE 65-45-12, QT450-10
- Threaded: ASME B1.20.1, ISO 7-1, GB 7306
- Surface: P: Painted E: Electroplated B: Black S: Epoxy G: Hot-dip Galvanized

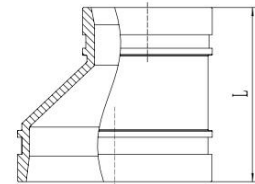

Available size

SIZE		OD SIZE	L (MM)
3"×2"	DN80×DN50	88.9X60.3	89
3"×2 1/2"	DN80×DN65	88.9X76.1	102
4"×3"	DN100×DN80	108.0X88.9	102
4"×2"	DN100×DN50	114.3X60.3	102
4"×2 1/2"	DN100×DN65	114.3X76.1	102
4"×3"	DN100×DN80	114.3X88.9	102
5"×3"	DN125×DN80	139.7X88.9	102
5"×4"	DN125×DN100	139.7X114.3	102
6"×3"	DN150×DN80	159.0X88.9	102
6"×4"	DN150×DN100	159.0X108.0	102
6"×4"	DN150×DN100	159.0X114.3	102
6"×2 1/2"	DN150×DN65	165.1X76.1	102
6"×3"	DN150×DN80	165.1X88.9	102
6"×4"	DN150×DN100	165.1X114.3	102
6"×5"	DN150×DN125	165.1X139.7	102
6"×3"	DN150×DN80	168.3X88.9	102
6"×4"	DN150×DN100	168.3X114.3	102
6"×5"	DN150×DN125	168.3X139.7	102
8"×3"	DN200×DN80	219.1X88.9	127
8"×4"	DN200×DN100	219.1X114.3	127
8"×5"	DN200×DN125	219.1X139.7	127
8"×6"	DN200×DN150	219.1X165.1	127
8"×6"	DN200×DN150	219.1X168.3	127