

Malleable Iron 45° Street Elbow

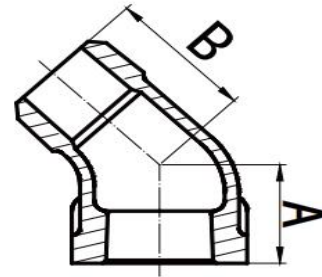

- Certificate: FM Approved / UL Listed / BSI / LPCB / NSF 61
- Size: DN6 - DN100
- Pressure: 2.5 Mpa / PN25
- Dimensions: BS EN10242
- Material: Malleable iron BS EN1562
- Threaded: BSPP (ISO228) / BSPT (ISO7-1)
- Surface: Black / Electrical galvanized / Hot-dip galvanized



Available size

SIZE		A (MM)	B (MM)
1/8"	DN6	16	21
1/4"	DN8	18.5	24
3/8"	DN10	20	25
1/2"	DN15	22	28
3/4"	DN20	25	32
1"	DN25	28	37
1 1/4"	DN32	33	43
1 1/2"	DN40	36	46
2"	DN50	43	55
2 1/2"	DN65	49.5	65
3"	DN80	55	76
4"	DN100	66	94