

Malleable Iron 45°Y Branch

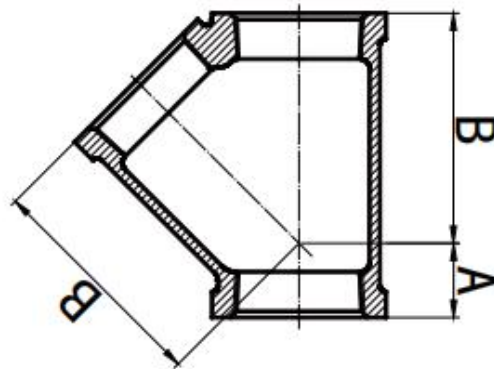

- Certificate: FM Approved / UL Listed / BSI / LPCB / NSF 61
- Size: DN15 - DN100
- Pressure: 2.5 Mpa / PN25
- Dimensions: BS EN10242
- Material: Malleable iron BS EN1562
- Threaded: BSPP (ISO228) / BSPT (ISO7-1)
- Surface: Black / Electrical galvanized / Hot-dip galvanized



Available size

SIZE		A (MM)	B (MM)
1/2"	DN15	15.5	43.4
3/4"	DN20	18.3	52
1"	DN25	21.6	61.7
1 1/4"	DN32	26	74.2
1 1/2"	DN40	27.9	83.3
2"	DN50	31.5	99.8
2 1/2"	DN65	38.6	120
3"	DN80	43.4	141
4"	DN100	51	177